

INTERMEDIATE POST

STRAINER POST

VEHICLE GATE

CORNER POST

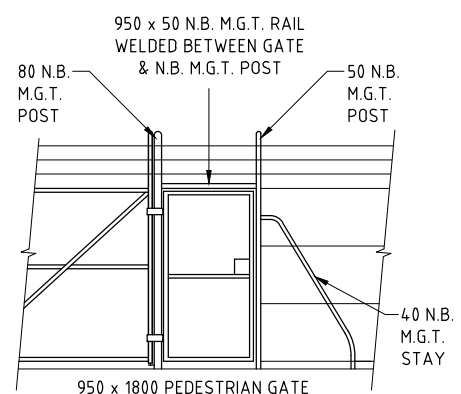

PEDESTRIAN ADJ. TO MAIN POST

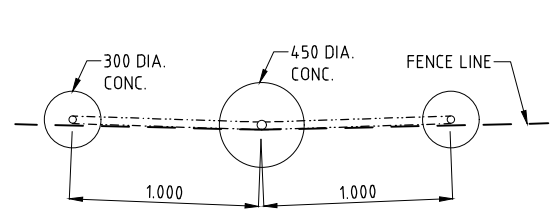

STRAINER POST FOOTINGS

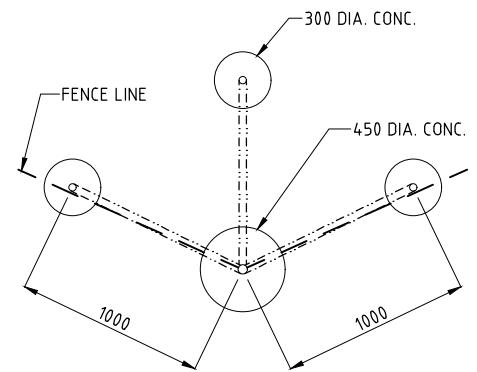

CORNER POST FOOTINGS FOR CORNERS GREATER THAN 90°

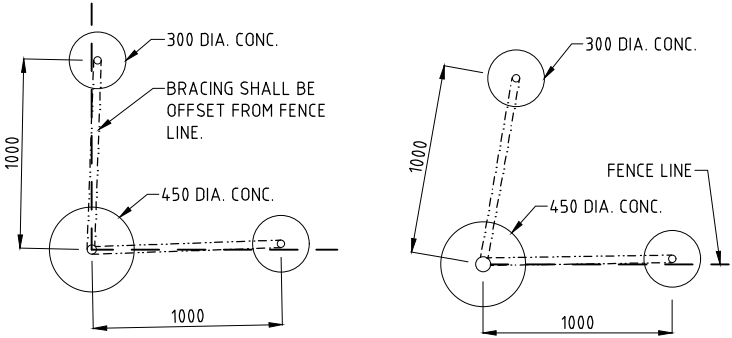

CORNER POST FOOTINGS

GATE POST FOOTINGS

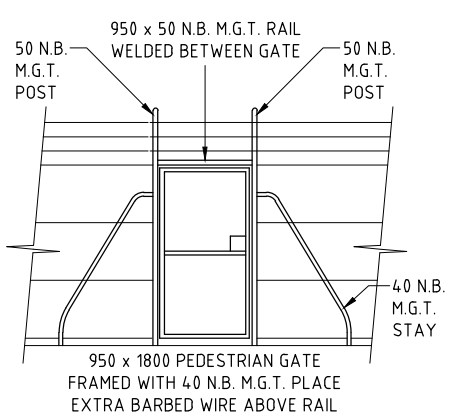

PEDESTRIAN GATE ON FENCE LINE

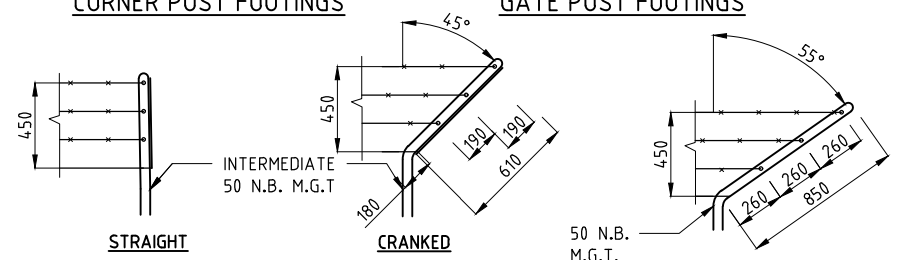

STRAIGHT BARBED WIRE SPACING INTERMEDIATE & STRAINER POSTS

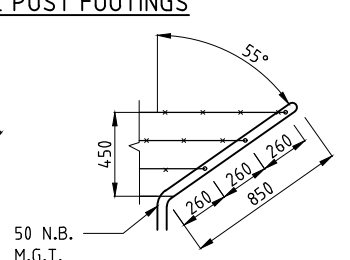

BARBED WIRE SPACING CORNER POSTS ONLY

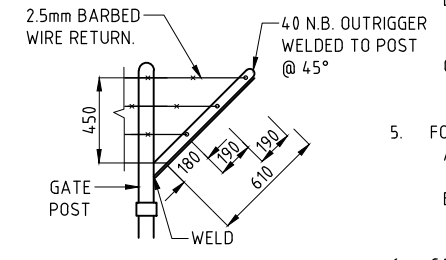

BARBED WIRE RETURN TO GATE POSTS

NOTE:

- REFERENCE DOCUMENT AS 1725.1-2010.
- ALL DIMENSION ARE IN MILLIMETRES UNLESS NOTED OTHERWISE.

CONSTRUCTION NOTES:

- ALIGNMENT:
 - A - THE FENCE SHALL BE CONSTRUCTED TO LINES SHOWN ON THE SITE PLAN. CHAINWIRE MESH SHALL BE ON OUTSIDE OF FENCE AND ALL SUPPORTING STRUCTURES SHALL BE WITHIN SECURE AREA UNLESS OTHER WIRE DIRECTED. BARBED WIRE SHALL NOT INTRUDE INTO PRIVATE PROPERTY.
- SPACING:
 - A - CORNER POST SHALL BE PLACED AT ALL DEFLECTIONS IN FENCE LINE.
 - B - STRAINER POSTS SHALL BE LOCATED AT CHANGES OF GRADE AND DIRECTION AND EVENLY SPACED AT INTERVALS NOT EXCEEDING 29.7 METRES.
 - C - INTERMEDIATE POSTS SHALL BE EVENLY SPACED BETWEEN GATE, CORNER AND STRAINER POSTS AT INTERVALS NOT EXCEEDING 3.3 METRES.
- FOOTINGS:
 - A - TO DIMENSIONS SHOWN SPOIL FROM EXCAVATION TO BE SPREAD WHERE DIRECTED BY SUPERINTENDENT.
 - B - 300 DIA. x 300 DEEP CONCRETE WITH 32 N.B. SOCKET SHALL BE PLACED TO HOLD VEHICLE GATES OPEN. ALL FOOTINGS TO BE TROWELLED SMOOTH WITH 1 IN 10 FALL FROM POST.
- CABLE WIRE SHALL BE TURNED TWICE AROUND STRAINER POSTS AND TRIPLE TWISTED. WIRE TO BE TENSIONED BY WIRE STRAINER TO SUPERINTENDENT'S SATISFACTION.

- CHAINWIRE MESH SHALL BE SECURED TO CABLE WIRES AT 300 CENTRES WITH APPROVED STAPLE DEVICE OR BY GALVANISED WIRE TIES, - TWICE TURNED AND TRIPLE TWISTED.
- SECURITY CHAIN OF APPROVED GAUGE & LENGTH SHALL BE WELDED TO GATES AS DIRECTED BY SUPERINTENDENT. HEAVY DUTY PADLOCK AND TWO LABELLED KEYS TO BE SUPPLIED BY CONTRACTOR.

MATERIALS:

- M.G.T = GALVANISED TUBE
- VEHICLE GATES, ARRANGEMENT AS SHOWN USE SINGLE LEAF FOR OPENING UP TO 3700.
- FOR 2440 WIDE CHAINWIRE MESH THE FOLLOWING MATERIAL CHANGES APPLY:
 - A - ADDITIONAL CABLE WIRE AT 620 CENTRES.
 - B - INTERMEDIATE POST INCREASED FROM 40 N.B. TO 50 N.B.
 - C - HEIGHT OF STAY/POST CONNECTION TO BE 2000.
- POST CAPS - MALLEABLE CAST IRON OR PRESSED 3.2MM GALVANISED MILD STEEL.
- CABLE WIRE - TWIN STRAND 3.15mm DIA GALVANISED WIRES TWISTED TOGETHER.
- TIE WIRE - 2MM SOFT MILD STEEL GALVANISED WIRE.
- BARBED WIRE - DOUBLE STRAND 2.5MM CONTINUOUS FILLET WELD.
- ALL GATE FITTINGS SHALL BE HEAVY DUTY GALVANISED.
- CONCRETE SHALL BE CLASS N25 AND SHALL BE MIXED AND PLACED ACCORDING TO THE DIPL SPECIFICATIONS FOR ROAD WORKS.

No.	DESCRIPTION	DATE	NAME	DEPT/COMPANY
2	NOTES AND CABLE WIRE UPDATED	APR 2018	S.JALIL	EES/DIPL
1	NOTES UPDATED	SEP 2017	J.LEESON	EES/DIPL
0	ISSUED AS A STANDARD DRAWING	SEP 2017	J.LEESON	EES/DIPL

WARNING
 BEWARE OF UNDERGROUND SERVICES.
 THE LOCATIONS OF UNDERGROUND SERVICES ARE APPROXIMATE ONLY AND THEIR EXACT POSITION SHOULD BE PROVEN ON SITE. NO GUARANTEE IS GIVEN THAT ALL EXISTING SERVICES ARE SHOWN.

DRAWN J.LEESON	CHECKED S.HATZI
DATE APRIL 2017	DATE APRIL 2017
DESIGNED	CHECKED
DATE	DATE
DESIGN LEADER S.HATZI	DESIGN DIRECTOR S.JACKSON
DATE 1/09/2017	DATE 1/09/2017



STANDARD DRAWINGS KERBING, FENCING & LANDSCAPING				
1800mm SECURITY FENCE				
FILE No.	ASSET No.	SHEET No.	DRAWING No.	AMEND.
-	-	1 OF 1	CS-3308	2
				SHEET SIZE A1