

SHARED PATH TYPE A (ASPHALT SURFACE)

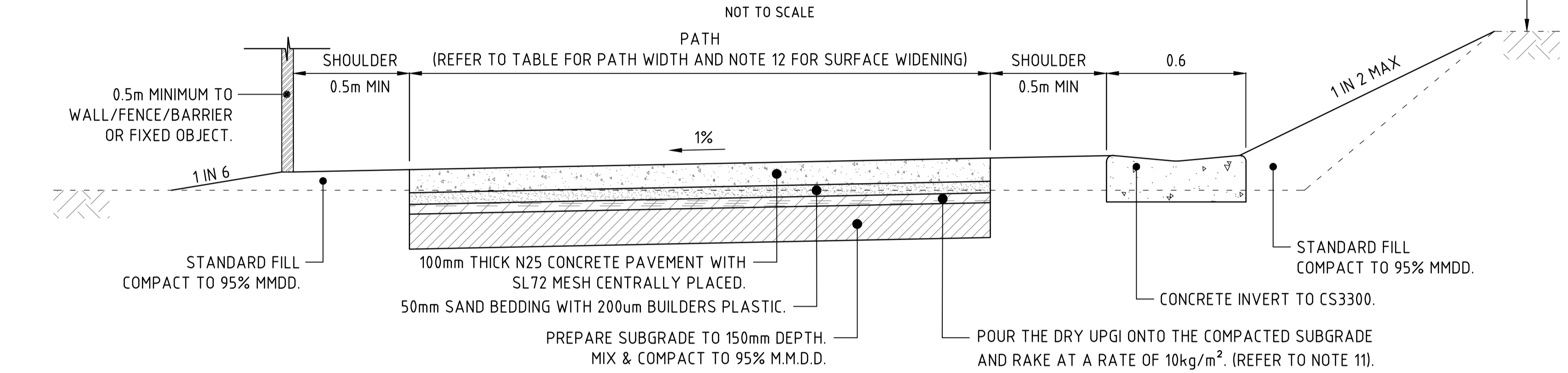

SHARED PATH TYPE B (CONCRETE SURFACE)

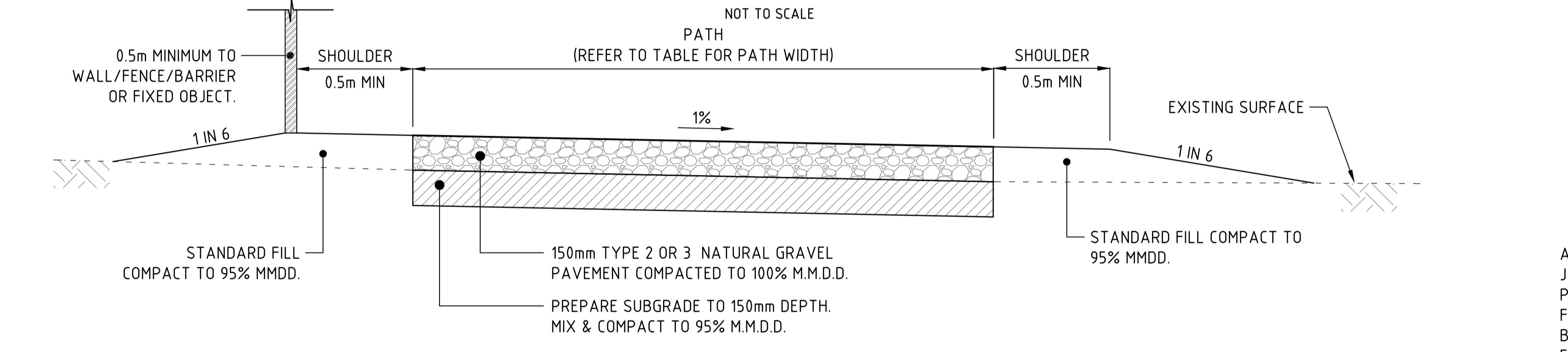

SHARED PATH TYPE C (GRAVEL SURFACE)

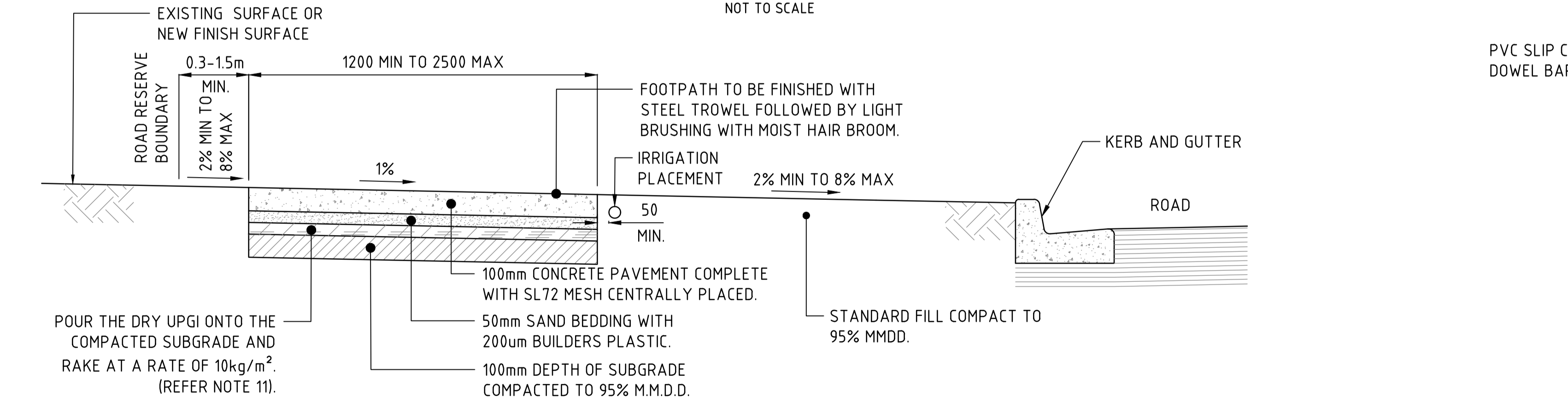

FOOTPATH SECTION PATHWAY TYPE A OR TYPE B

	PATH WIDTH (m)		
	LOCAL ACCESS PATH	COMMUTER PATH	RECREATIONAL PATH
DESIRABLE MINIMUM WIDTH	2.5	3.0	3.5
MINIMUM WIDTH - TYPICAL MAXIMUM	2.5 ¹ - 3.0 ²	2.5 ¹ - 4.0 ²	3.0 ¹ - 4.0 ²

NOTE:
 1. A LESSER WIDTH SHOULD ONLY TO BE ADOPTED WHERE CYCLIST VOLUMES AND OPERATIONAL SPEEDS WILL REMAIN LOW.
 2. A GREATER WIDTH MAY BE REQUIRED WHERE THE NUMBER OF CYCLIST AND PEDESTRIANS ARE VERY HIGH OR THERE IS A HIGH PROBABILITY OF CONFLICT BETWEEN USERS (E.G. PEOPLE WALKING DOGS, ROLLER BLADDERS AND SKATERS ETC.).

	PATH WIDTH (m)	
	LOCAL ACCESS PATH	MAJOR PATH
DESIRABLE MINIMUM WIDTH	2.5	3.0
MINIMUM WIDTH - TYPICAL MAXIMUM	2.5 ¹ - 3.0 ²	2.5 ¹ - 4.0 ²

NOTE:
 1. A LESSER WIDTH SHOULD ONLY TO BE ADOPTED WHERE CYCLIST VOLUMES AND OPERATIONAL SPEEDS WILL REMAIN LOW.
 2. A GREATER WIDTH MAY BE REQUIRED WHERE THE NUMBER OF CYCLIST IS VERY HIGH.

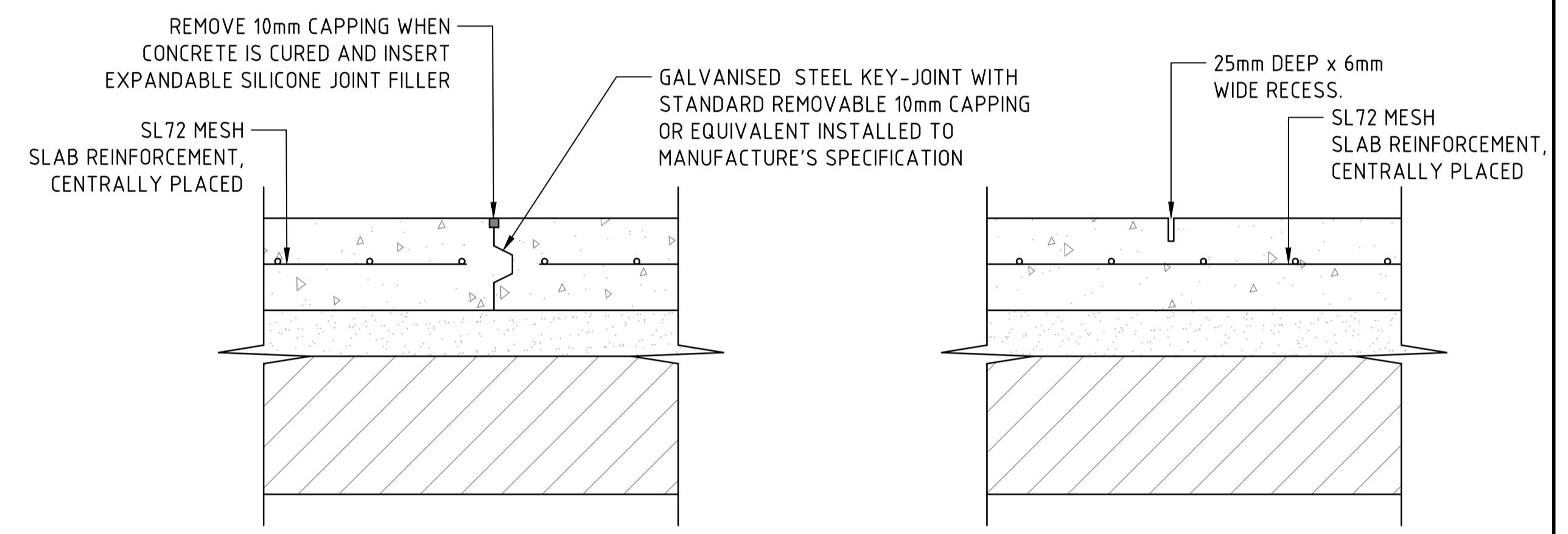

KEYED EXPANSION JOINT DETAIL (CONCRETE CONSTRUCTION)

TOOL JOINT DETAIL (CONCRETE CONSTRUCTION)

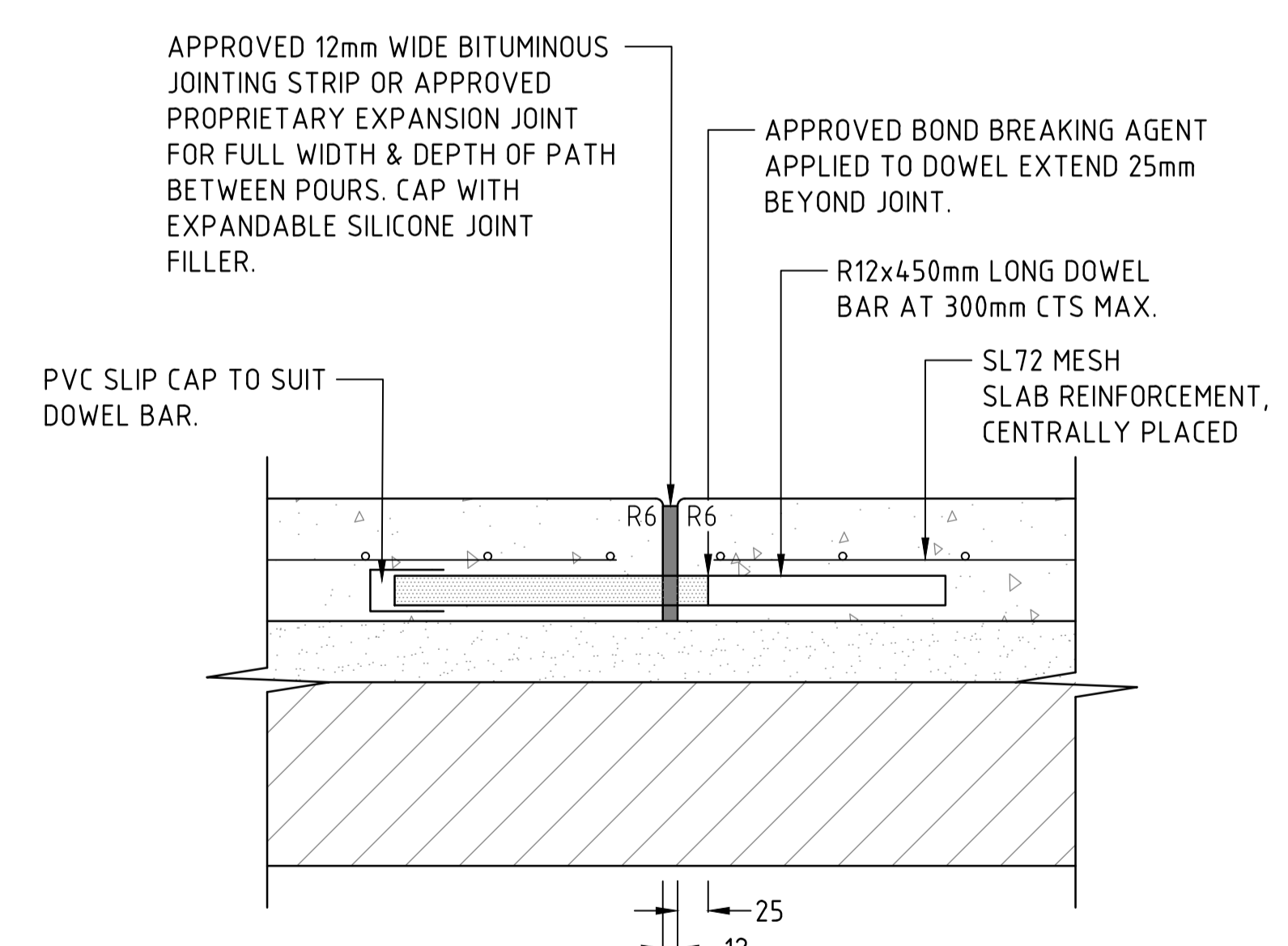

ALTERNATIVE EXPANSION JOINT DETAIL (CONCRETE CONSTRUCTION)

- NOTES**
- ALL DIMENSIONS ARE IN MILLIMETRES UNLESS NOTED OTHERWISE.
 - TOOL JOINTS TO CONCRETE AT 2m CENTRES.
 - EXPANSION JOINTS TO CONCRETE AT 6m CENTRES.
 - IRRIGATED AREAS 50mm TOPSOIL TO FSL PATH NON-IRRIGATED: NO TOPSOIL GRAVEL TO FSL OF PATH.
 - TOPSOIL COMPACTED WITH SMALL PLATE COMPACTOR OR LIGHT WHEEL ROLLED.
 - 80mm DIAMETER SERVICE CONDUIT TO BE PLACED UNDER PATH EVERY 200m.
 - A) FLUSH WITH CONCRETE SURFACE AT TOOL OR EXPANSION JOINTS.
B) FLUSH WITH ASPHALTIC SURFACE EVERY 200m.
 - ADJUST FILL LAYER WHEN GRASSING BATTERS TO ACCOUNT FOR TOPSOIL.
 - SERVICE MARKER IRR (IRRIGATION CONDUIT) TO BE INSTALLED INTO THE CONCRETE ON EITHER EDGE OF THE FOOTPATH. TO BE PLACED 50mm FROM THE EDGE.
 - TIE IN TO EXISTING PATH NEATLY.
 - CENTRELINE LINE MARKING MAY APPLY AS DIRECTED BY SUPERINTENDENT OR WHERE PATHWAY MAXIMUM WIDTHS ARE USED.
 - WHERE SUBGRADE IS ABOVE EXISTING NATURAL SURFACE, A LAYER OF UNDER PATH GROWTH INHIBITOR (UPGI) IS REQUIRED TO BE POURED AND SPREAD BY RAKING AT A RATE OF 10 kg/m².
 - PROVIDE EDGE LINE WHERE PATH IS ADJACENT TO WALL/FENCE/BARRIER OR HAZARD. EXTEND SURFACE 100mm EACH SIDE TO ACCOMMODATE EDGE LINE MARKING.

No.	DESCRIPTION	DATE	NAME	DEPT./COMPANY
7	MINOR CHANGES	JAN 2024	D.LLANO	DIPL
6	UPGI SPRAY RATE, CONCRETE INVERT, FENCE ADDED	SEP 2021	N.K	EES
5	UPGI DETAILS AMENDED	AUG 2020	S.SHI	EES
4	NOTES FOR EXPANSION JOINT AMENDED	DEC 2019	S.SHI	EES/DIPL
0	ISSUED AS A STANDARD DRAWING	SEPT 2017	J.LEESON	EES/DIPL

WARNING
 BEWARE OF UNDERGROUND SERVICES.
 THE LOCATIONS OF UNDERGROUND SERVICES ARE APPROXIMATE ONLY AND THEIR EXACT POSITION SHOULD BE PROVEN ON SITE. NO GUARANTEE IS GIVEN THAT ALL EXISTING SERVICES ARE SHOWN.

DRAWN J.LEESON DATE MAR 2017	CHECKED S.HATZI DATE MAR 2017
DESIGNED N.KNIBBS DATE DEC 2014	CHECKED B.O'DONNELL DATE DEC 2014
DESIGN LEADER S.HATZI DATE 1/09/2017	DESIGN DIRECTOR S.JACKSON DATE 1/09/2017



STANDARD DRAWINGS		TYPICAL CROSS SECTIONS		CYCLE AND PEDESTRIAN SHARED PATH		TYPICAL CROSS SECTIONS AND DETAILS	
FILE No.	ASSET No.	SHEET No.	DRAWING No.	AMEND.	SHEET SIZE		
-	-	1 OF 1	CS3006	7	A1		